

**NOTES**

- BINDERS ARE ATTACHED TO OPENING WITH 3/8" x 1" THREADED CUTTING SCREWS FOR STEEL JAMBS OR 3/8" WEDGE ANCHORS FOR MASONRY JAMBS.
- FOR ALTERNATE CLOSING SYSTEMS (WEIGHTS TO THE REAR, REEL TO THE FRONT, AND REEL TO THE REAR) SEE "SHEET 1000AL1".

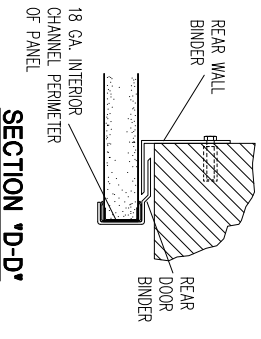

**SAINO SERIES 1000**  
**SAINO SERIES 2000, 250° F. TEMP. RISE**  
 MANUAL DOOR WITH WEIGHT CLOSING SYSTEM  
 U.L. LABELED MODULAR DOORS

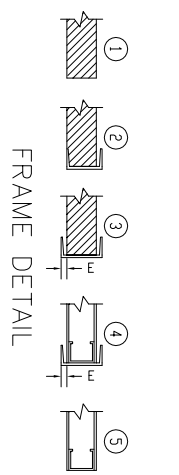

TAG MARK	DOOR TYPE	OPENING		SLIDE PLAN	FINISH DOOR		NO. OF PANELS	WALL THICKNESS	FRAME DETAIL	E	WEIGHTS		REEL		CLEARANCE REQ'D		U.L. LABEL	CRUSH PLATES	TRACK-HOOD	WEATHER-STRIPPING	LOCKING SYSTEM	REMARKS
		WIDTH	HEIGHT		WIDTH	HEIGHT					FRONT	REAR	FRONT	REAR	CLS. SIDE	OPNG. SIDE						

Tel: (800) 543-4455  
 www.chasedoors.com  
 FAX: (800) 978-6570

JOB	CUSTOMER NO:	NO. PRINTS	FOR	DATE	REVISED
SOLD TO	CHASE ORDER NO:				
	DRAWN BY:				
	SHEET ___ OF ___				