

PROLINE 250°  
V-CAM HINGE  
 (STANDARD)

"E" SERIES HINGE  
 OPTIONAL

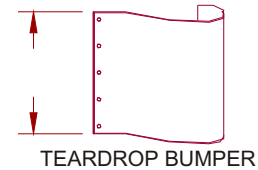
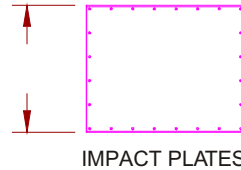
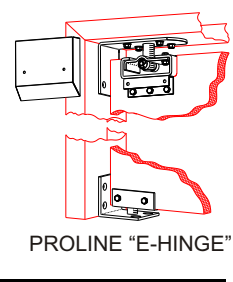
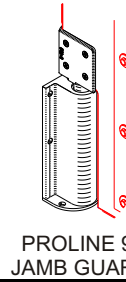
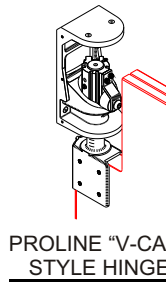

**SPECIFICATIONS:**

DOORS SHOWN AS INSULATED \_\_\_ OR SOLID CORE \_\_\_ DOOR, DOUBLE ACTING, SHALL BE MODEL \_\_\_ DOOR AS MANUFACTURED BY CHASE INDUSTRIES, INC., TO FIT DOOR OPENING \_\_\_ WIDE BY \_\_\_ HIGH.

**SKIN SELECTION:**

300/350 ABS IN VARIOUS COLORS.  
(SPECIFY COLOR:)  BEIGE  CHOCOLATE BROWN  
 BURGUNDY  NAVY  ROYAL BLUE  JADE  RED  
 METALLIC GRAY  CLOUD GREY  FOREST GREEN  
 MEDIUM BROWN  CADET BLUE  BLACK  WHITE

300/350 FRP IN VARIOUS COLORS.  
(SPECIFY COLOR:)  WHITE  BEIGE  ALMOND  GRAY

400 METAL  
(TYPE:)  STAINLESS STEEL  GALVANIZED

**GASKETS: (PICK ONE)**

NO GASKET  FULLY GASKETED  
 PARTIALLY GASKETED

**POLYCARBONATE VISION PANEL:** TO BE SHATTER-PROOF AND SET IN TWO PIECE ABS FRAMES.

SW-SPECIAL WINDOWS(PICK ONE)  
 8"w x16"h  10"w x16"h  16"w x16"h  
 17"w x23"h  23"w x23"h  
 WB-WINDOW BARS

**SPECIFY QUANTITY:** \_\_\_\_\_

BIPARTING  SINGLE  
IF SINGLE;  RIGHT OR  LEFT HAND SWING

Charges will be assumed by buyer for changes to work in process. Buyer hereby accepts responsibility for all sizes and dimensions. This order will not be processed until all acknowledgment forms are signed and returned.

Specifications Accepted

By: \_\_\_\_\_ Date: \_\_\_\_ / \_\_\_\_ / \_\_\_\_

**IMPACT PLATE (BOTH SIDES):**  YES  NO  
 PE-POLYETHYLENE IMPACT PLATES  
(SPECIFY COLOR:)  BROWN  GREY  GREEN  
 BLACK  
IMPACT PLATE HEIGHT:  
 12"  18"  24"  36"  48"  
 SS-STAINLESS STEEL  
 GS-GALVANIZED STEEL  
 DP-DIAMOND PLATE

**TEARDROP BUMPERS (BOTH SIDES):**  YES  NO  
-CROSS-LINKED POLYETHYLENE  
 STANDARD  INDUSTRIAL  
 CG-CART GUARDS - BLACK  
(SPECIFY LOCATION) \_\_\_\_\_

**SPECIAL OPTIONS AS INDICATED BELOW:**

-JG-JAMB GUARDS  
 3" (STD)  9"  12"  18"  
 OJG-OVERSIZED JAMB GUARDS - 9"  
 SR-STEEL REINFORCED SPINE  
 SA-SPRING ASSISTED HINGE  
 PP-PUSH PLATES  
 LS-LOCK SLEEVES

**SPECIAL NOTES/OBSTRUCTIONS:** \_\_\_\_\_  
\_\_\_\_\_  
\_\_\_\_\_

**NOTE:**

- DRAWINGS NOT TO SCALE  
- JAMB FRAMES MUST BE WITHIN ±1/8" OF FOS.

MODEL # PROLINE TRAFFIC DOOR SPECIFICATIONS  
SINGLE AND BIPARTING PANELS

**CUSTOMER INFORMATION**

ACKNOWLEDGMENT # \_\_\_\_\_  
P.O. NUMBER \_\_\_\_\_

**Chase Doors**  
World's Leading Manufacturer Of Traffic Doors  
Cincinnati Ohio, and Redmond Oregon  
Phone Toll Free: 1-800-543-4455

DATE \_\_\_\_\_ CHASE APPROVAL \_\_\_\_\_

FORM # SD4172

REV.