

MODEL#: 200 Series
Security (Not 200 Series)

QTY: **FINISHED OPENING:**
COLOR:

QUOTE ORDER **PO#:**

STYLE
 Double Single
 Left Right

GASKETING
 FULLY GASKETED
 * PARTIALLY GASKETED
 FRONT
 BACK
 BOTTOM

SEALS
 TOP SEAL
 UPPER HINGE SEAL

200 SERIES REQUIREMENTS

- 90° X 90° HARDWARE
- DOUBLE PANE WINDOW
- SECURITY BARS IN WINDOW
- BUMPER 38" HIGH TEARDROP COLOR
- KICKPLATE 38" HIGH COLOR
- LOWER HINGE GUARD (Aluminum)
- TOP CANEBOLTS
- BOTTOM CANEBOLTS
- 2" LOCKING DEVICE
- DIRECTIONAL SIGNS
- TAMPER PROOF FASTENERS

- * 180° X 90° HARDWARE
- * SINGLE PANE WINDOW
- NO-RISE HARDWARE
- LO-RISE HARDWARE
- WELD PLATES

*** NOT A 200 SERIES OPTION**

FLOW CHART: IF THIS BOX IS CHECKED OR YOU ARE USING MORE THAN ONE COLOR OF BUMPER/KICKPLATE, PLEASE FILL OUT THE ADJACENT FLOW CHART.

WRITE IN COLOR OF BUMPERS/KICKPLATES.
 INDICATE WHICH SIDE OF OPENING CANEBOLTS ARE TO BE LOCATED ON BY CHECKING THE APPROPRIATE BOX.

NOTES:

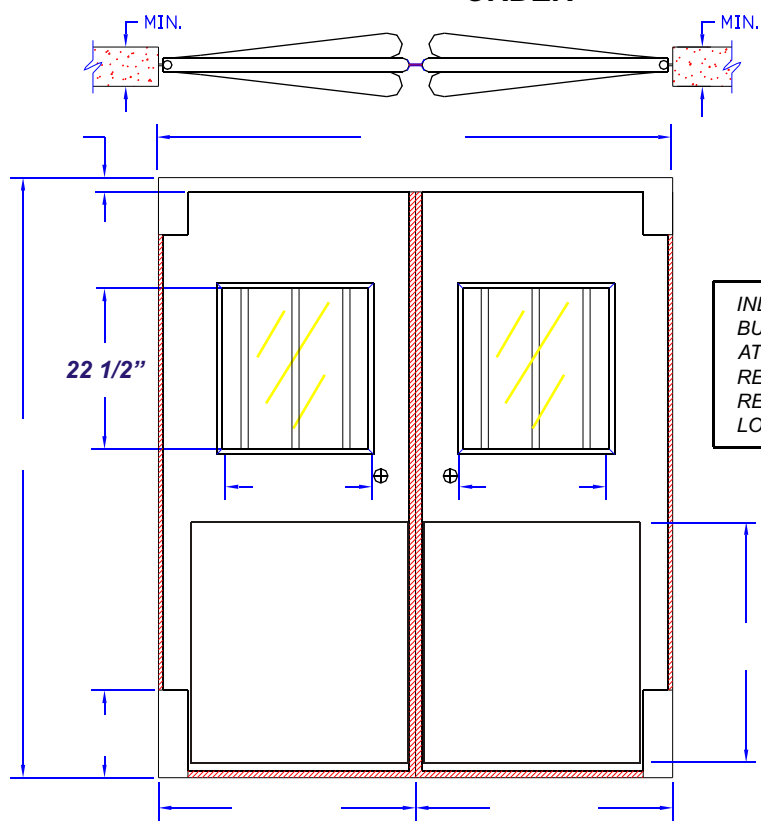

BUMPER/KICKPLATE COLOR	CANEbolt SIDE	BUMPER/KICKPLATE COLOR	BUMPER/KICKPLATE COLOR	CANEbolt SIDE	BUMPER/KICKPLATE COLOR
BUMPER/KICKPLATE COLOR	CANEbolt SIDE	BUMPER/KICKPLATE COLOR	BUMPER/KICKPLATE COLOR	CANEbolt SIDE	BUMPER/KICKPLATE COLOR
BUMPER/KICKPLATE COLOR	CANEbolt SIDE	BUMPER/KICKPLATE COLOR	BUMPER/KICKPLATE COLOR	CANEbolt SIDE	BUMPER/KICKPLATE COLOR
BUMPER/KICKPLATE COLOR	CANEbolt SIDE	BUMPER/KICKPLATE COLOR	BUMPER/KICKPLATE COLOR	CANEbolt SIDE	BUMPER/KICKPLATE COLOR

DURULITE SECURITY DOOR SHOP DRAWING

DATE

TO:
 JOB:

Chase Doors
 World's Leading Manufacturer Of Traffic Doors
 Cincinnati Ohio, and Redmond Oregon • www.chasedoors.com
 Phone Toll Free: 1-800-543-4455 • FAX: 1-800-978-6570