

**Polyethylene Spring Bumper**  
 Order By: Curl Size, Height of Bumper,  
 Opening Width and Color

QTY: \_\_\_\_\_  
 Bumper Height: \_\_\_\_\_  
 Opening Width: \_\_\_\_\_  
 Color: \_\_\_\_\_

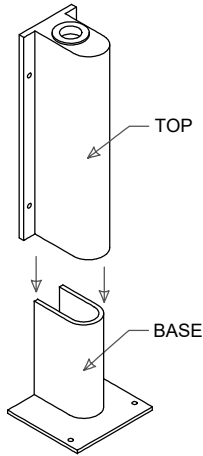

**ADJUSTABLE HINGE GUARD**  
 "Aluminum ONLY"  
 PART # D05KTADJLH  
 QTY: \_\_\_\_\_

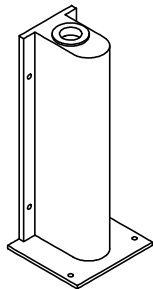

**LOWER HINGE GUARD**  
 "Aluminum"  
 PART # D05ASHGRTC  
 QTY: \_\_\_\_\_

**LOWER HINGE GUARD**  
 "Stainless Steel"  
 PART # D05AS9090C  
 QTY: \_\_\_\_\_

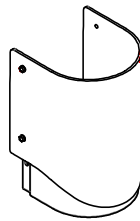

**"NEW STYLE"**  
 UPPER HINGE SEAL  
 PART # D05KTHS008 (KIT)  
 PART # D05PPHSRAP (SEAL)  
 QTY: \_\_\_\_\_

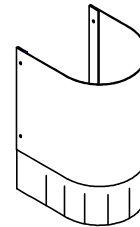

**"OLD STYLE"**  
 UPPER HINGE SEAL  
 PART # D0MGS0014  
 QTY: \_\_\_\_\_

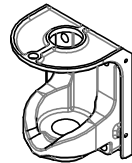

**UPPER "V-CAM" HINGE ASSEMBLY**  
 ("One Piece" Full Composite)  
 PART # D05AS55290  
 QTY: \_\_\_\_\_  
 (With "HOLD OPEN" Option)  
 PART # D05ASRETHO  
 QTY: \_\_\_\_\_



**"NOSING"**  
 PVC Gasket Retainer for Back and  
 Bottom Edges of Panel (102" Long)  
 PART # D05PP0908E  
 QTY: \_\_\_\_\_



**ROLLER ASSEMBLY**  
 PART # D05AS5508C  
 QTY: \_\_\_\_\_

**ROLLER ASSEMBLY w/  
 Stainless Steel Bearing**  
 PART # D05AS5508S  
 QTY: \_\_\_\_\_

1/8" Poly, Frame & Fasteners (Front & Back - Single Pane)

Size	Part Number	Qty
8" x 14"	D05KT0814W	
12" x 18"	D0MPK01218	
16" x 16"	D0MPK01616	
17" x 23"	D0MPK01723	

1/8" Poly, Frame & Fasteners (Front & Back - Double Pane)

Size	Part Number	Qty
8" x 14"	Not Available	
12" x 18"	D0MPK1218D	
16" x 16"	D0MPK1616D	
17" x 23"	D0MPK1723D	

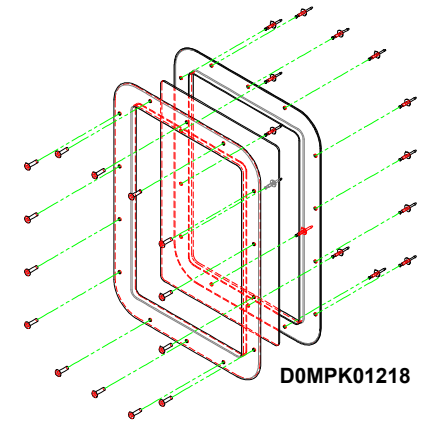

**D0MPK01218**

**ADA APPROVED WINDOW KITS**

1/8" Poly, Frame & Fasteners (Front & Back - Single Pane ONLY)

Size	Part Number	Qty
10" x 30" ADA	D05KT1030A	
12" x 30" ADA	D05KT1230A	
16" x 30" ADA	D05KT1630A	
20" x 30" ADA	D05KT2030A	
24" x 30" ADA	D05KT2430A	

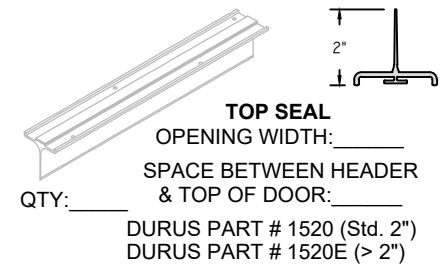

**TOP SEAL**  
 OPENING WIDTH: \_\_\_\_\_  
 SPACE BETWEEN HEADER  
 & TOP OF DOOR: \_\_\_\_\_  
 QTY: \_\_\_\_\_  
 DURUS PART # 1520 (Std. 2")  
 DURUS PART # 1520E (> 2")

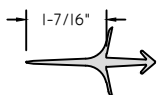

**D0MGS01628**  
**1628**  
 (STD Leading  
 Edge Single)

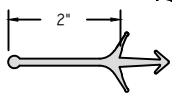

**D0MGS00719**  
**1535**  
 (STD Leading  
 Edge Double)

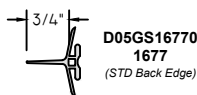

**D05GS16770**  
**1677**  
 (STD Back Edge)

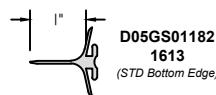

**D05GS01182**  
**1613**  
 (STD Bottom Edge)

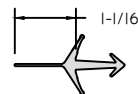

**D0MGS00870**  
**1560**  
 (Leading Edge)

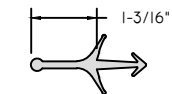

**D0MGS00686**  
**1558**  
 (Leading Edge)

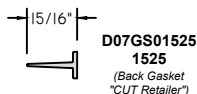

**D07GS01525**  
**1525**  
 (Back Gasket  
 "CUT Retailer")

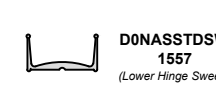

**D0NASSTDSW**  
**1557**  
 (Lower Hinge Sweep)

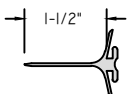

**D05GS09306**  
**1615**  
 (Old Style  
 Leading Edge)

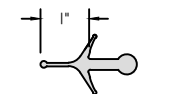

**D0MGS00722**  
**1545**  
 (Leading Edge)

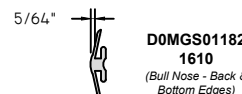

**D0MGS01182**  
**1610**  
 (Bull Nose - Back &  
 Bottom Edges)

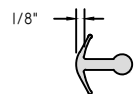

**D0MGS1559F**  
**1559**  
 (Leading Edge)

**RETAILER GASKETS\***  
 90° X 90° Hardware Only

Part Number	Durus #	Qty
*D05GS16282	1628	
*D0MGS00719	1535	
*D05GS16779	1677	
*D05GS01182	1613	
D0MGS00870	1560	
D0MGS00686	1558	
D05GS01525	1525	
*D0NASSTDSW	1557	
D05GS09306	1615	
D0MGS01545	1545	
D0MGS01182	1610	
D05GS16282	1559	

\*Standard Gaskets

**DURULITE® RETAILER**  
 90° X 90° Hardware Only

PART REPLACEMENT ORDER FORM

