

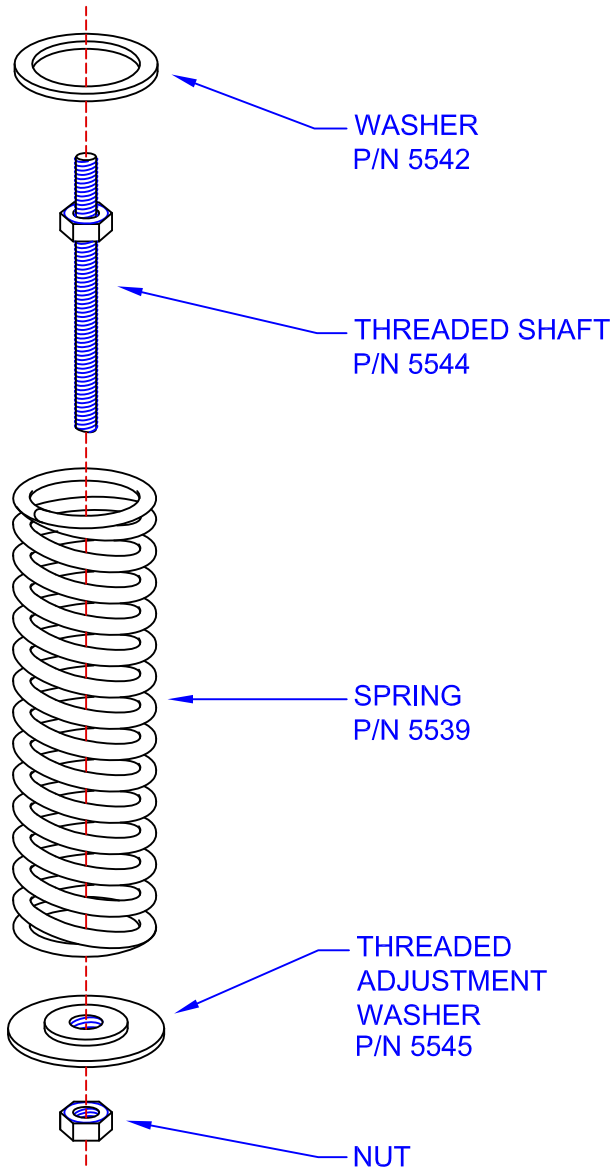

## Adjustable Spring Assist Installation



### INSTALLATION INSTRUCTIONS

**IMPORTANT:** MAKE SURE THAT "ROLLER ASSEMBLY" IS PROPERLY MOUNTED AND PINNED BEFORE PROCEEDING.

**CAUTION:** SPRING COILS MUST NOT TOUCH EACH OTHER WHEN DOOR IS IN THE OPEN POSITION. OVERTIGHTENING THE SPRING WILL CAUSE SEVERE DAMAGE TO THE ROLLER ASSEMBLY.

1. INSERT THREADED SHAFT (P/N 5544) INTO LOWER HINGE PIN UNTIL JAMB NUT IS BOTTOMED OUT, THEN TAKE HALF TURN ON JAMB NUT WITH OPEN-END WRENCH.
2. SLIDE THIN WASHER (P/N 5542) OVER THREADED SHAFT. SLIDE SPRING (P/N 5539) OVER SHAFT. THREAD ADJUSTMENT WASHER (P/N 5545) UNTIL IT IS JUST STARTED ON THE THREADED SHAFT.
3. TIGHTEN THE THREADED ADJUSTMENT WASHER (P/N 5545) ON THE THREADED SHAFT (P/N 5544) UNTIL THE DESIRED CLOSING ACTION IS OBTAINED.
4. PLACING OPEN-END HAND WRENCHES ON THE ADJUSTMENT WASHER (P/N 5545) AND ON THE JAMB NUT, TURN ONE AGAINST THE OTHER TO LOCK ADJUSTMENT WASHER IN PLACE.

SPRING ASSIST

N.T.S.