

SECTION 'A-A'

SAINO SERIES 3000
SAINO SERIES 4000, 250° F. TEMP. RISE

MANUAL DOOR WITH WEIGHT CLOSING SYSTEM
U.L. LABELED MODULAR DOORS

SLIDE PLAN

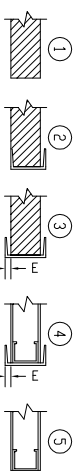

FRAME DETAIL

NOTES

- BINDERS ARE ATTACHED TO OPENING WITH 3/8" x 1" THREADCUTTING SCREWS FOR STEEL JAMBS OR 3/8" KIMB BOLTS FOR MASONRY JAMBS.
- FOR ALTERNATE CLOSING SYSTEMS (WEIGHTS TO THE REAR, REEL TO THE FRONT, AND REEL TO THE REAR) SEE "SHEET 3000ALT".

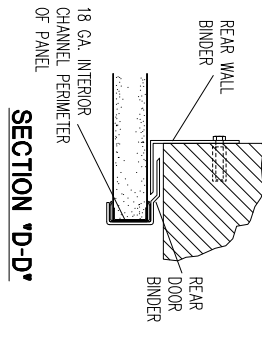

SECTION 'D-D'

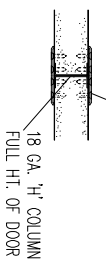

SECTION 'C-C'

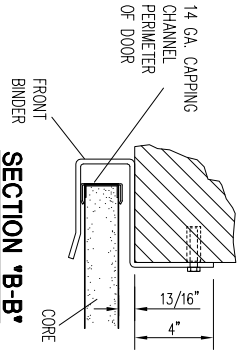

SECTION 'B-B'

TAG MARK	DOOR TYPE	OPENING		SLIDE PLAN	FINISH DOOR		NO. OF PANELS	WALL THICKNESS	FRAME DETAIL	E	WEIGHTS		REEL		CLEARANCE REQ'D		U.L. LABEL	CRUSH PLATES	TRACK-HOOD	WEATHER-STRIPPING SYSTEM	LOCKING SYSTEM	REMARKS
		WIDTH	HEIGHT		FRONT	REAR					FRONT	REAR	QLOS. SIDE	OPNG. SIDE	HEAD							

Chase Doors
Tel: (800) 543-4455
www.chasedoors.com
FAX: (800) 978-6570

JOB	CUSTOMER NO:	NO. PRINTS	FOR	DATE	REVISED
	CHASE ORDER NO:				
SOLD TO	DRAWN BY:	SHEET	OF		