

QTY: _____ MODEL#: _____ FINISHED OPENING: _____
 COLOR: _____

QUOTATION
 ORDER
 PO# _____

DURULITE DOOR

GASKETING

- FULLY GASKETED
 PARTIALLY GASKETED
 FRONT _____
 BACK _____
 BOTTOM _____

FASTENERS FOR

- STEEL JAMB
 WOOD JAMB

SEALS

- TOP SEAL
 EXTENDED _____ GAP
 UPPER HINGE SEAL
 LOWER HINGE SEAL

OPTIONS

- 90° X 90° HARDWARE
 180° X 90° HARDWARE
 SINGLE PANE WINDOW
 DOUBLE PANE WINDOW
 BUMPER _____ HIGH TEARDROP
 COLOR _____
 KICKPLATE _____ HIGH
 COLOR _____
 LOWER HINGE GUARD
 ROTO ALUM ST/STEEL
 SPRING ASSIST
 LOW-RISE
 NO-RISE
 HOLD OPEN
 WELD PLATES
 LOCKING DEVICE _____
 TOP/BOTTOM CANEBOLTS

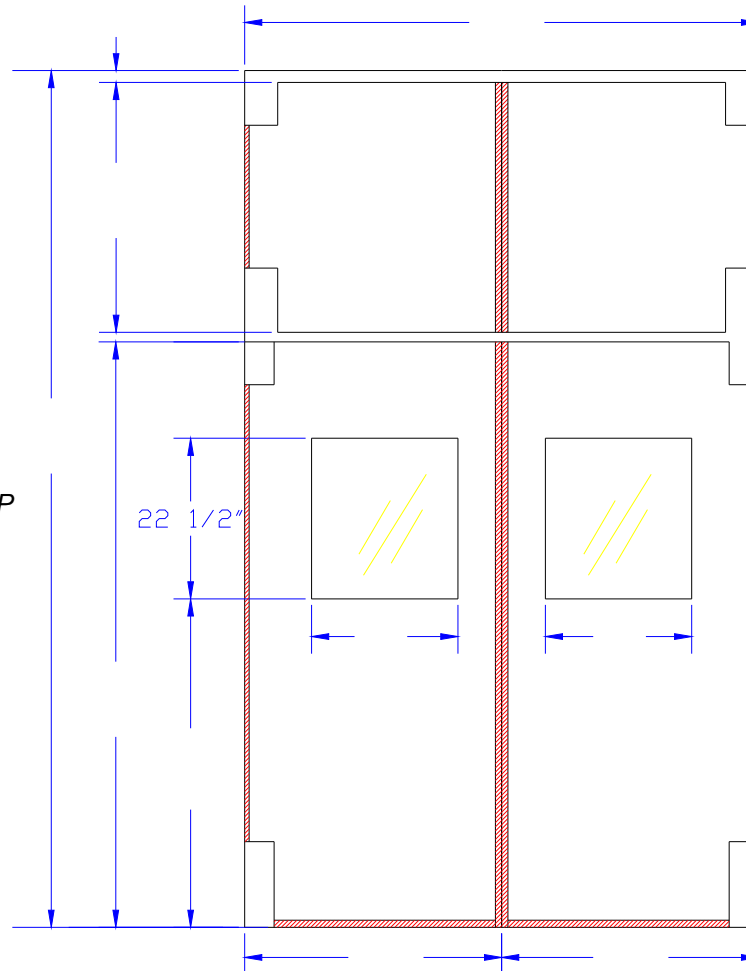
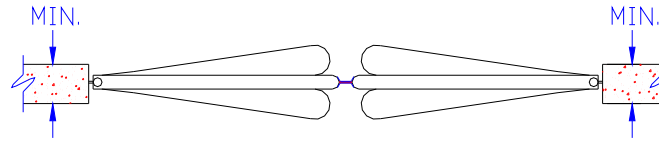

DUTCH DOOR

GASKETING

- FULLY GASKETED
 PARTIALLY GASKETED
 FRONT _____
 BACK _____

FASTENERS FOR

- STEEL JAMB
 WOOD JAMB

SEALS

- UPPER HINGE SEAL
 DUTCH MIDDLE HINGE SEAL

OPTIONS

- 90° X 90° HARDWARE
 180° X 90° HARDWARE
 BUMPER _____ HIGH TEARDROP
 COLOR _____
 KICKPLATE _____ HIGH
 COLOR _____
 SPRING ASSIST
 LOW-RISE
 NO-RISE
 HOLD OPEN
 WELD PLATES
 LOCKING DEVICE _____

INDUSTRIAL DOORS WITH BUMPERS,
 SEE ATTACHMENT FOR
 RECOMMENDED OR REQUIRED
 POST LOCATIONS.

NOTES: _____

DRAWN BY _____ DATE _____

DRAWING NAME:
 SHOP-05.DWG

TO: _____

JOB: _____

Chase Doors
 World's Leading Manufacturer Of Traffic Doors
 Cincinnati Ohio, and Redmond Oregon • www.chasedoors.com
 Phone Toll Free: 1-800-543-4455 • FAX: 1-800-978-6570

DURULITE DUTCH DOOR SHOP DRAWING